

THE MESSENGER NEWSLETTER

SEASONS GREETINGS - WINTER EDITION 2009

WESLEY SERVICES ORGANIZATION



Special Announcement from Stephen Smookler, Executive Director

Just as you are reading these words, Wesley Community Services will be moving into our beautiful new home at 2091 Radcliff Drive in Price Hill next door to the Hamilton County Emergency Operations Center. Our new location will improve our ability to serve seniors and the disabled. First, we will be more efficient with all operations under one roof. Secondly, we will have additional refrigeration space to improve the services for our Meals-On-Wheels clients. Thirdly, we will have more space to take on new programs and services to meet future challenges and needs. We certainly have come a long way since 1999 when we occupied the Steiner Street Rectory off River Road in Sedamsville. This has all been possible through the unprecedented support from our donors. If you are interested in visiting our new facility please contact me at 661-2777.

P.S. Additional funds for our senior programs are urgently needed. Your holiday donation is greatly appreciated. Thank you in advance for your generosity.

Inside this issue:

Lincoln Crawford Annual Fund Campaign Update - 2

Lincoln Crawford Receives Bequest & Christmas Wish List - 3

Wesley Community Services In the Spotlight - 4

Meals-On-Wheels Driver Celebrates 11th Year - 5

A Special Thank You to Our Treasured Donors - 6 & 7

WesleyLinks Partners - 8



Lincoln Crawford Annual Fund Campaign Update

Lincoln Crawford conducts a Prayer Breakfast each year to bring supporters together to request God's help for achieving a successful annual fund campaign. The Prayer Breakfast for 2009 was held on Saturday, September 19th, at the New Vision United Methodist Church. This year's event was the most successful to date as evidenced by attendance of just under 300 participants with a combination of table sales and offerings totaling \$10,630.

Continued on Page 2 . . .

Lincoln Crawford
Nursing and
Rehabilitation Center
Board of Trustees
2009

President

Leonard Garrett
*Garrett & Assoc. Material
Consultants, Owner*

Treasurer

Thomas Lockwood
*Peck, Shaffer &
Williams, LLP, Attorney*

Secretary

Juanita M. Adams
*City of Cincinnati,
Director of Vital
Records/Registrar (Ret.)*

Trustees

Dr. Lewis E. Bunton
*The Bunton Group,
President*

Charlotte T. McManis
*St. Susanna Parish,
Business Manager*

Willa Shelby
*City of Cincinnati,
Health Department (Ret.)*

Bishop Dwight Wilkins
*Macedonia Living Word
Fellowship Church*

Trustee Emeritus

Elizabeth Mills
*City of Cincinnati WIC
Health Program (Ret.)*

Michael J. Scott
Executive Director

1346 Lincoln Ave.
Cincinnati, Ohio
45206

(513) 861-2044

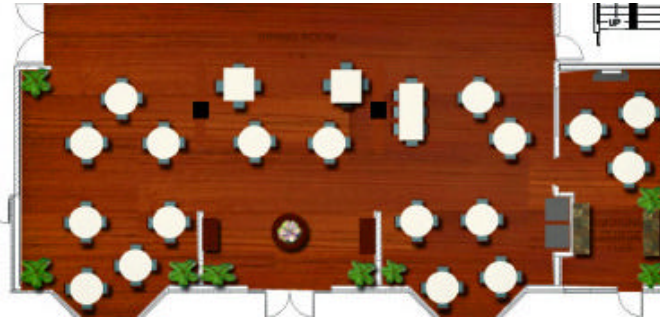

Schematic of the floor plan for the new Lincoln Crawford Nursing and Rehabilitation Center Resident Dining Room

Continued from cover page . . .
The Reverend Sherwin O. Ealy, Pastor of Pilgrim Missionary Baptist Church, served as keynote speaker. His message focused on the scripture that "God Loves a Cheerful Giver." The morning provided an excellent opportunity for all in attendance to extend prayers and petitions for God's intercession to guide efforts in achieving our goal to raise sufficient funds to renovate the Resident Dining Room.

Efforts began in 2008 to raise funds for the much needed renovation of the Resident Dining Room. DNK Architects were retained to assist in the planning and development of the construction plans for the renovation. The scope of the renovation will require approximately \$400,000 according to estimates provided by the architects.

The dining room renovation project is very important in providing for the quality of life for Lincoln Crawford Residents. The current dining room stands relatively unchanged since the building was dedicated in 1982. Hard surfaces, cinder block walls and hand-me-down furniture are all items that need enhanced to achieve Resident comfort. The dining experience plays a vital role in the health and socialization of Residents.

Three times per day Residents will have the opportunity to enjoy the dining room and the positive atmosphere will encourage Residents to take in more nutrition and improve their physical and psychosocial well-being.

In addition, the renovation will open the room into one large space and allow for community events and expanded area for internal programs to occur.

The Dining Room Project is a colossal undertaking by Lincoln Crawford. However, the need for the improvements are instrumental to the growth and capability of appropriately caring for our Residents. In mid November, appeal letters will be sent to over 1,000 individuals, churches, organizations, and foundations to seek help in making our goal a reality. A little over \$40,000 has been collected to date. We will need everyone's support to make our efforts successful. Our petitions have been delivered at the prayer breakfast for success. With God's help and yours we will begin construction by June 2010!



*Lincoln Crawford
Christmas Wish List*

We are rapidly approaching the holiday season, which brings many programs and events to our Residents. The building will soon be decorated from head to toe with wreaths, trees, and angels. During this festive time, our Residents enjoy outings to the Conservatory, Sharon Woods, Fountain Square and driving around to see Christmas lights. Many groups will come to Lincoln Crawford to sing carols or bring gifts to the Residents. If you would like to help bring the holidays to our Residents, please contact Janice Snow at (513) 861-2044.



*Lincoln Crawford
Receives Bequest*

Lincoln Crawford was recently informed that the Estate of Cleo P. Gill has designated the facility as a beneficiary of her trust. It is believed that Mrs. Gill's mother, Mrs. Addie Bell Pullins, was a Resident at Lincoln Crawford some twenty years ago. It was through this exposure and her desire to acknowledge the care her mother received, that Lincoln Crawford has been bequeathed a sizeable gift. These funds provide "manna from heaven" to help Lincoln Crawford continue its ministry to serve the health care needs of Residents primarily supported by the Medicaid program. The gift is particularly meaningful at a time when government funding for senior support programs such as Medicare and Medicaid are seeing significant reductions.

There are many options available for individuals to make a meaningful gift to Lincoln Crawford that will help perpetuate the 121 year tradition of providing quality health care services. Please consider one of the gifting methods listed on the right to provide future support for Lincoln Crawford's ministry.

**7 Ways You Can
Leave a Legacy™**

- Prepare a Will. Without a Will, you lose control of the assets you worked a life-time to acquire.
- Leave a specific dollar amount or a percentage of the assets in your Will to your favorite charity. These can include, but are not limited to: stocks, bonds, CD's, real estate, vehicles, art and jewelry.
- Name your favorite charity as the beneficiary of your IRA or pension plan.
- Purchase a new life insurance policy naming your favorite charity as the beneficiary.
- Name your favorite charity as the beneficiary of an existing life insurance policy.
- Remember deceased loved ones with memorial gifts to charities.
- Encourage family members and friends to give gifts to charities in their Wills.

Are you interested in increasing your retirement income through a planned gift? Please call our Development Office at 513/389-3096 for assistance.

Leave a Legacy™ is an initiative of the Greater Cincinnati Planned Giving Council.

Wesley Community
Services
Board of Trustees
2009

President

Daniel C. Heyd
*Graydon Head & Ritchey
LLP, Partner*

Treasurer

Thomas A. Kaylor
*Laboratory Partners, Inc.,
Corporate Controller*

Assistant Treasurer

Harry Minnich
*Bank One, Vice President
(Ret.)*

Secretary

Michael C. Berry
*Northern Kentucky
University, Director of
Educational Talent Search
(Ret.)*

Assistant Secretary

David Warren
*Children's Hospital,
Corporate Counsel*

Trustees

Joe Acito
*Elder High School
Director of Alumni Affairs*

Ron Kruse
*KLR Associates, Inc.,
President*

Charee Maddux
*Delhi Flower & Garden
Center, Owner*

Stephen Smookler
Executive Director

2091 Radcliff Drive
Cincinnati, Ohio
45204
(513) 661-2777

visit us on the web at
www.wesleycs.org



Tim Cappel, President, Humana Ohio (left), Stephen Smookler, Executive Director, Wesley Community Services, and Stephen Ringel, Vice President, Cincinnati Customer Care.

Humana Greater Cincinnati Benefits Award Received

In September Wesley Community Services was proud to be named one of three finalists in the 2009 Humana Greater Cincinnati Benefits Program. Wesley received \$10,000 to help equip Medical Transportation and Meals-On-Wheels drivers with mobile computing devices designed to improve the efficiency and effectiveness of our services. The award is a great honor for Wesley because nearly 90 non-profit agencies competed for the \$100,000 first place award.

Wesley Community Services shares in the fun at the City of Montgomery's "My Dog's Got Talent Show"

Wesley Community Services showcased its Pet Portions and PetKare programs at the City of Montgomery's "My Dog's Got Talent Show" held Saturday, September 26th in Montgomery Park. The Pet Portions and PetKare programs aim to provide Meals-On-Wheels clients with free high-nutrition pet food and veterinary services for their cats and dogs.

Testimonials from the Heart ~

A Home Care Services client wrote to us to say:

*"I cannot find adequate words to express my thanks for your consideration of me. Your generosity of time spent and work involved is just so sweet and kind. You lift my spirit and my day. My appreciation and thanks are from my heart."
Sincerely, Mrs. C*

A Meals-On-Wheels client wrote to us to say:

*"We and many seniors deeply thank you for providing us with the half gallon containers of milk and thank you for our good Meals-On-Wheels. They mean so much to us and help us to stay in our home which we have been in for 60 years. You have a great crew and wonderful deliverers."
Thank you, Mr. and Mrs. C*

Weekly Meals-On-Wheels Clients will Select Desserts!

Beginning in January, weekly clients will select their juices/fruits and desserts. Clients will enjoy a selection from fresh seasonal fruit or 100% fruit juice. They will also be able to choose from a long list of 20 desserts! This is all possible by our move to the new Radcliff facility that has additional storage space. Be on the lookout for your favorite goodies.



Meals-On-Wheels Driver Celebrates 11th Year On the Job

Ray Schweitzer, who recently turned 74, marked his 11th year delivering Meals-On-Wheels for Wesley Community Services. Ray says that his earlier jobs as a driver education teacher and school bus driver were also rewarding but he loves his

Meals-On-Wheels clients. “I don’t just deliver meals” Ray says. “I know it sounds a bit silly but I tell folks that I treat the client like they were my mother.” Ray has delivered all these years in the Delhi, Sedamsville, Saylor Park neighborhoods. He starts his day as a crossing guard at Bridgetown Middle School and Oakdale Elementary. He likes to do little things for his clients like bring in their newspaper and set back their emptied garbage cans. “One of my clients can’t go out down the steps to get her newspaper and so I get it every day for her. I don’t know what she would do if I didn’t get it” Ray comments. Wesley Community Services is honored to have Ray looking out for our Meals-On-Wheels clients.

Fall Prevention Tips – Worth Sharing

Did you know? Forty percent of nursing home admissions are related to falls, and about 1 out of every 3 Americans over 65 experience a fall every year. At our WesleyLinks November 4th network meeting, Birdie Wickerham, Health Educator, Hamilton Cty. Public Health Dept., and Hamilton Cty. Fall Prevention Task Force spokesperson, shared the following steps to reduce your risk of falling:

Exercise Regularly. (Talk to your doctor if you are a beginner.)

Talk to Your Doctor About the Medications You are Taking. (Taking four or more medications increases your risk of falling.)

Have Your Eyes Checked Yearly. (Poor eyesight increases your risk of falling.)

Remove Home Hazards. (Install good lighting; use handrails on both sides of stairways, bathtub, and toilet; put adhesive treads in bathtub and shower; put non-slip backing on throw rugs; remove clutter and electrical cords from walkways; keep commonly used items in easy-to-reach storage areas.)

Use Caution on Slippery or Uneven Surfaces.

Don’t Rush! (Avoid lightheadedness by taking your time getting out of bed or standing, if you have been sitting for a long time.)

Wear Supportive, Rubber Soled Shoes.

For more information, go to www.fallpreventiontaskforce.org and www.LearnToFall.com, or call Ms. Wickerham at 513/946-7802.

Wesley Community Services Supporting Seniors and Disabled

Home Delivered Meals

- Daily or weekly delivery
- Lunch or dinner delivery times
- Nutritionally balanced meals
- Physician-prescribed Senior Choice Meals™ for individuals with cardiac disease, kidney disease, diabetes, and swallowing/chewing problems

Specialized Transportation

- Six (6) days a week transportation
- Door-to-door service
- Evening transports
- On time-all the time service
- Wheelchair accessible vans
- Comfortable cars

Home Care Services

- Cleaning services
- Grocery shopping, errands, and cooking
- Assistance with bill paying and banking
- Bonded/Insured home care specialists



The Mission of Wesley Services Organization through Lincoln Crawford Nursing and Rehabilitation Center and Wesley Community Services would not be possible without the generosity from our treasured donors.

We are forever grateful for your continued financial support - Thank You!

Donors to Wesley Services Organization through Lincoln Crawford Nursing and Rehabilitation Center and Wesley Community Services have been suppressed in accordance to our website privacy policy.





WESLEY SERVICES ORGANIZATION

3333 Glenmore Avenue
Cincinnati, Ohio 45211
(513) 389-3096

ADDRESS SERVICE
REQUESTED

Nonprofit
U.S. Postage
PAID
Cincinnati, OH
Permit No. 529

Mailing Address Line 1

Mailing Address Line 2

Mailing Address Line 3

Mailing Address Line 4

Mailing Address Line 5

May We Help You With Your Outreach Ministry To Seniors?

WesleyLinks is an interdenominational consortium of area faith based ministries created by Wesley Community Services to enable partner churches to better serve seniors in their congregations. Services are made available to seniors who need support so that they may stay in their own home for as long as possible. WesleyLinks meets at member churches for a luncheon and informative program. If you are interested in having your church be a WesleyLinks partner contact Stephen Smookler at 661-2777.

The WesleyLinks Family of Churches

Include:

Anderson Hills UMC
Armstrong Chapel UMC
Brecon UMC
Calvary UMC
Cherry Grove UMC
Christ New Beginnings
Ministries
Christ Prince of Peace UMC
Church of the Saviour UMC
Cincinnati Christian University
Clifton UMC
Clough UMC
Eden Chapel UMC
Elberon UMC
Epiphany UMC
First Baptist Church of Dent
First Church of God
Forest Chapel UMC
Friendship UMC
Gaines UMC

Grace Lutheran Church
Hartwell UMC
Hartzell UMC
Hyde Park Community UMC
Immaculate Heart of Mary Parish
John Wesley UMC
Kenwood Baptist Church
Keys of the Kingdom UMC
Knox Presbyterian Church
Loveland UMC
Miami Whitewater UMC
Monfort Heights UMC
Mt. Carmel Christian Church
Mt. Healthy UMC
Mt. Washington UMC
Nast Trinity UMC
New Vision UMC
North Bend UMC
Oak Hills UMC
Our Lady of Lourdes Church
Our Lady of Visitation Catholic
Church
Parkside Christian Church
Pilgrim United Church of Christ
Sharonville UMC

Shiloh UMC
St. Aloysius Gonzaga Catholic
Church
St. Bernard Catholic Church
St. Ignatius Catholic Church
St. James Episcopal Church
St. Joseph Catholic Church
North Bend
St. Lawrence Catholic Church
St. Luke's Evangelical Church
of Christ
St. Martin of Tours Catholic
Church
St. Peter and St. Paul United
Church of Christ
St. Timothy's Episcopal Church
St. Vincent DePaul/St. Bernard
Clairvaux Church
Vineyard Community Church
Vineyard Westside
Westwood First Presbyterian
Church
Westwood UMC
Zion UMC

Wesley Services
Organization
Board of Trustees 2009

Chairman/President

Ray M. Blankenship
*Western Southern Life Insurance,
Executive Vice President (Ret.)*

Treasurer

Thomas Lockwood
Peck, Shaffer & Williams, LLP, Attorney

Secretary

Richard K. Smith
*Procter & Gamble, Associate
Director Purchasing (Ret.)*

Assistant Secretary

Daniel C. Heyd
Graydon Head & Ritchey LLP, Partner

Trustees

Juanita M. Adams
*City of Cincinnati,
Registrar/Director of Vital Records (Ret.)*
Leonard Garrett

*Garrett & Associates Material
Consultants, Owner*

Thomas A. Kaylor
*Laboratory Partners, Inc.,
Corporate Controller*

Robert A. Schilling
Champlin/Haupt, Partner

Trustees Emeritus

Frank A. Dawson
*City of Cincinnati,
Director of Finance (Ret.)*