

Wesley Services Organization

Spring Edition 2009

THE MESSENGER NEWSLETTER . . .



Wesley Community Services' mission of providing Meals-on-Wheels, Specialized Transports, and Homemaker Services to a rapidly expanding senior population is growing more than ever since it began in 1992.

Meals-On-Wheels increased from 224,672 in 2007 to 247,423 in 2008, an increase of 22,751 meals, or over 10%. When added to the 2,770 meals Wesley provided to Humana Medicare subscribers, as part

of a nationwide program through the national Meals-On-Wheels Association of America (MOWAA), Wesley Community Services provided over a quarter of a million meals in 2008.

Physician prescribed Senior Choice™ therapeutic meals for seniors needing a special diet because of renal or kidney disease, high blood pressure, diabetes, or problems with chewing and swallowing, increased from 14,552 in 2007 to 24,953 in 2008, a whopping 71% increase.

One-way specialized transports increased by 36%, growing from 25,046 transports in 2007 to 34,141 in 2008. Not only does Wesley provide medical transports to seniors, it also works with the Hamilton County Board of MR/DD in transporting their clients to work sites, two local school districts in transporting special needs students to school, and the Salvation Army in transporting their senior clients to adult day care centers.

Homemaker Services increased from 18,067 hours in 2007 to 21,471 hours in 2008, an increase of 3,404 hours, or 19%.

The Wesley Community Services Board of Trustees is exceedingly grateful to our many supporters for making this expansion possible. **Thank You!**

Inside this issue:

Lincoln Crawford Annual Fund Campaign Update	2
What's new at Lincoln Crawford?	3
Five elected officials volunteer for March for Meals 2009	4
Pet Portions Program receives second \$5,000 grant	5
A Special Thank You to our Treasured Donors	6-7
WesleyLinks Partners	8

Progress is occurring on Lincoln Crawford's ambitious goal of raising \$200,000 for the renovation of the Resident Dining Room.



To date, a total of \$28,052 has been generously donated by individuals, churches, businesses and organizations toward this greatly needed project. There are a number of very encouraging contacts that have been initiated to explain our project and encourage potential donors to support our goal. The need for the renovation has been acknowledged during our conversations with potential donors and we anticipate some substantial gifts will be forthcoming. *Continued on page 2.*

Lincoln Crawford
Nursing and
Rehabilitation Center
Board of Trustees
2009

President

Leonard Garrett
*Garrett & Assoc. Material
Consultants, Owner*

Treasurer

Thomas Lockwood
*Peck, Shaffer &
Williams, LLP, Attorney*

Secretary

Juanita M. Adams
*City of Cincinnati,
Director of Vital
Records/Registrar (Ret.)*

Trustees

Dr. Lewis E. Bunton
*The Bunton Group,
President*

Charlotte T. McManis
*St. Susanna Parish,
Business Manager*

Willa Shelby
*City of Cincinnati,
Health Department (Ret.)*

Bishop Dwight Wilkins
*Macedonia Living Word
Fellowship Church*

Trustee Emeritus

Elizabeth Mills
*City of Cincinnati WIC
Health Program (Ret.)*

Michael J. Scott
Executive Director

1346 Lincoln Ave.
Cincinnati, Ohio
45206

(513) 861-2044

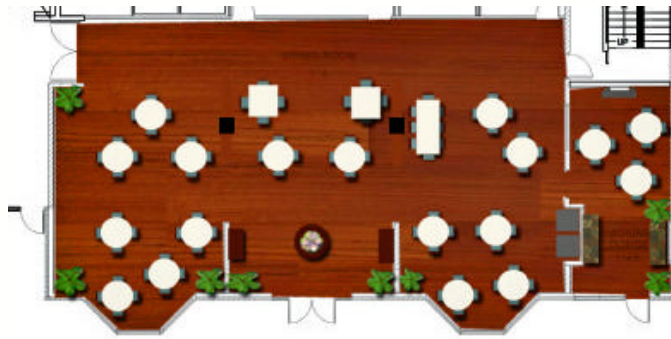

Schematic of the floor plan for the new Lincoln Crawford Nursing and Rehabilitation Center Resident Dining Room

Continued from cover page. Arrangements have been made with DNK Architects to proceed in developing the construction drawings. This phase of planning will provide for the development of specific detail in space planning, selection of furnishings and finishes.

The construction drawings will allow Lincoln Crawford to accurately establish the cost of the project and develop exacting graphics to share how the new space will look following renovation. Each of these benefits will be crucial in our continued fund raising efforts.

The accompanying schematic of the floor plan for the Dining Room renovation will give you an idea of the configuration of the renovated area. You can observe how the Dining Room space is enhanced and made more functional by the removal of the two barrier walls. The girders placed in the ceiling will accommodate the load-bearing walls being removed and there will only be 2 two foot by two foot pillars (represented by black squares). You will also note that very attractive bay windows have been introduced into the space and will remove the glaring sun from the prior "greenhouse" type windows. This will provide greater ease for temperature control of the area and provide an attractive venue for seeing outdoors. The center section of the Dining Room will have French doors that will enhance the outside view and complement a more "home-like" environment in the new Dining Room.

The Residents and staff are very excited and involved in the evolution of the Dining Room project. We will continue to share our vision with you as final reproductions are created through the development of the construction drawings. It will incentivize everyone to see the new finishes selections for the flooring, wall coverings and furniture to aggressively seek the donations necessary to support the Dining Room renovation.

Lincoln Crawford is very grateful for those who have contributed thus far. The magnitude of this project is very large and we need your assistance to make the renovation a reality. A contribution envelope is attached to this newsletter and provides you with the opportunity to take action by submitting a gift to support the renovation. Please help by making a generous contribution. Thank you in advance for supporting Lincoln Crawford's Residents and our mission of providing quality healthcare services.

7 Ways You Can Leave a Legacy™

- Prepare a Will. Without a Will, you lose control of the assets you worked a lifetime to acquire.
- Leave a specific dollar amount or a percentage of the assets in your Will to your favorite charity. These can include, but are not limited to: stocks, bonds, CD's, real estate, vehicles, art and jewelry.
- Name your favorite charity as the beneficiary of your IRA or pension plan.
- Purchase a new life insurance policy naming your favorite charity as the beneficiary.
- Name your favorite charity as the beneficiary of an existing life insurance policy.
- Remember deceased loved ones with memorial gifts to charities.
- Encourage family members and friends to give gifts to charities in their Wills.

Are you interested in increasing your retirement income? Please call our Development Office at 513/389-3096 for information.

Leave a Legacy™ is an initiative of the Greater Cincinnati Planned Giving Council.

During the past three years that I have been associated with Lincoln Crawford, I have been overwhelmed by the generosity of those who have supported Lincoln Crawford's mission with their financial gifts. It is very difficult to develop a reserve of funds from operations to purchase items that will enhance the quality of life for our Residents. This is the result of the high percentage of our population that is supported by the Medicaid Program. Federal and State funding of Medicaid continues to be constricted due to budget constraints. On the other hand, the expectation is to provide a higher level of service with reduced funding. This paradigm indicates that fundraising is our only alternative to purchase capital items that will enhance our environment and safety.



Prior to joining Lincoln Crawford Mr. Scott's resume includes senior management positions at The Drake Center, Maple Knoll, Twin Lakes, Marjorie P. Lee, and Twin Towers.

Contributions over the past three years have provided approximately \$330,816 for purchasing greatly needed items for resident enrichment. The items purchased include the following:

- **3 new commercial clothes dryers**
- **1 fifteen passenger wheel chair lift equipped bus**
- **3 bariatric beds**
- **56 new electric high/low beds**
- **2 handicap accessible sliding doors for ease of access**
- **1 portable Therapy Table**
- **4 new Hoyer lifts for patient transfer**
- **2 new Hoyer sit to stand patient lifts**
- **1 walk-in freezer for the kitchen**
- **1 walk-in refrigerator for the kitchen**
- **64 new Resident suites of furniture to include bedside table, chest of drawers and wardrobe**

As you can observe, the list of items is long and the items purchased have increased the comfort and well-being of our Residents. The purchases have improved safety and the ease of accessibility within their home. These improvements would never have been achievable without the generosity and compassion to reach out and help support Lincoln Crawford's Residents and ministry of service. Our donors have proven that our community is very benevolent in assisting those in need. We are truly blessed to have such generous support from friends, churches, businesses and organizations.

Come visit with us and get an opportunity to see how these gifts are supporting the quality of our Resident services. We would also be very pleased to discuss our current project of renovating our Resident Dining Room. This project is anticipated to cost between \$200,000 to \$250,000 and we will need significant help to achieve our goal. Please help by sending a contribution today!

**March-For Meals Volunteers
Join in on the Fun . . .**

On behalf of the Wesley Community Services Board of Trustees, volunteers and staff - thank you to the elected officials who graciously volunteered their time by delivering Meals-On-Wheels to seniors and individuals with disabilities in Greater Cincinnati during "March-for-Meals" week March 16th through March 20th.

**Vice Mayor David Crowley,
City of Cincinnati;**

**Mayor Charles Johnson,
City of Forest Park;**

**The Honorable David Pepper,
President, Hamilton County Board
Commission;**

**The Honorable William J. Seitz, III,
Ohio State Senator;**

**Vice Mayor Curtis Walden,
City of St. Bernard**

Wesley Community
Services
Board of Trustees
2009

President

Daniel C. Heyd
*Graydon Head & Ritchey
LLP, Partner*

Treasurer

Harry Minnich
*Bank One, Vice President
(Ret.)*

Secretary

David Warren
*Children's Hospital,
Corporate Counsel*

Trustees

Michael C. Berry
*Northern Kentucky
University, Director of
Educational Talent Search
(Ret.)*

Thomas A. Kaylor
*Laboratory Partners, Inc.,
Corporate Controller*

Ron Kruse
*KLR Associates, Inc.,
President*

Charee Maddux
*Delhi Flower & Garden
Center, Owner*

Stephen Smookler
Executive Director

3333 Glenmore Ave.
Cincinnati, Ohio
45211
(513) 661-2777

visit us on the web
at
www.wesleycs.org



Hamilton County Commissioner David Pepper (right) with MOW's client Geraldine Crandall (center) and MOW's driver Steve Martin (left)



Ohio State Senator William J. Seitz, III (left) with MOW's Barbara Mayr (center) and MOW's driver Joann Hopkins (right)



City of Cincinnati Vice Mayor David Crowley (left) with MOW's client Joe Grady (center) and MOW's driver Steve Martin (right)



City of St. Bernard Vice Mayor Curtis Walden with MOW's client Margaret Reichardt



City of Forest Park Mayor Charles Johnson (right) with MOW's client Joanne Koester (center) and MOW's driver Sue Ann Baker (left)

Testimonials from the Heart . . .

A Home Care client wrote us to say, "I cannot find adequate words to express my thanks for your consideration of me. Your generosity of time spent and work involved is just so sweet and kind. You lift my spirit and my day. My appreciation and thanks are from my heart."

A Meals-On-Wheels client wrote us to say, "Your service is excellent, thank you."

Pet Portions Program Receives \$5,000 Grant . . .

The Walter English and Sophie English Charitable Foundation provided a \$5,000 grant to benefit Wesley Community Services' Pet Portions program.

Wesley Community Services delivers 200 to 250 pounds of pet food weekly to Cincinnati area seniors and disabled.

The foundation is administered through the law firm of Ritter & Randolph, LLC. Mary Ann Jacobs, President, commented, "We are overjoyed from the success of Wesley Community Services Pet Portions program and will continue to do our part to ensure more seniors will benefit from this worthwhile initiative."

One More for the Fleet!



Pictured here is Jermaine Ballard, Medical Transport Driver, who has been with us almost 4 years with a perfect driving record! Our Specialized Transportation department has 20 vehicles including this brand new wheelchair assisted passenger van.

O' What A Meal We Enjoyed!



Wesley Community Services Meals-On-Wheels personnel and volunteers prepared and delivered **887 delicious St. Patrick's Day dinners** consisting of all-time-favorite corned beef and kraut, Irish green mashed potatoes, buttered green beans, and tasty shamrock cookies.



Wesley Community Services

Home Delivered Meals

- Daily or weekly delivery
- Lunch or dinner delivery times
- Nutritionally balanced meals
- Physician-prescribed Senior Choice Meals™ for individuals with cardiac disease, kidney disease, diabetes, and swallowing/chewing problems

Specialized Transportation

- Six (6) days a week transportation
- Door-to-door service
- Evening transports
- On time-all the time service
- Wheelchair accessible vans

- Comfortable cars

Home Care Services

- Cleaning services
- Grocery shopping, errands, and cooking
- Assistance with bill paying and banking
- Bonded/Insured home care specialists



Many, many thanks to the seven area Banfield Pet Hospitals - Western Hills, Eastgate, Colerain, Springdale, Hyde Park, Mason, and Bridgewater Falls who collected pet food from their customers to give to Wesley Community Services "Pet Portions" program.

The Mission of Lincoln Crawford Nursing and Rehabilitation Center and Wesley Community Services would not be possible without the generosity from our treasured donors. We are forever grateful for your continued financial support - Thank You! Gifts from January 1st through December 31st 2008 . . .

The names of donors to Lincoln Crawford Nursing and Rehabilitation Center and Wesley Community Services have been suppressed in accordance to our website privacy policy.

Wesley Services
Organization Board of
Trustees 2009

Chairman/President

Ray M. Blankenship
*Western Southern Life Insurance,
Executive Vice President (Ret.)*

Treasurer

Thomas Lockwood
*Peck, Shaffer & Williams, LLP,
Attorney*

Secretary

Richard K. Smith
*Procter & Gamble, Associate
Director Purchasing (Ret.)*

Assistant Secretary

Daniel C. Heyd
*Graydon Head & Ritchey LLP,
Partner*

Trustees

Juanita M. Adams
*City of Cincinnati,
Registrar/Director of Vital
Records (Ret.)*

Leonard Garrett
*Garrett & Associates Material
Consultants, Owner*

Robert A. Schilling
Champlin/Haupt, Partner

Trustees Emeritus

Rev. Dr. L.H. Mayfield
Christ Hospital, Chaplain (Ret.)

Frank A. Dawson
*City of Cincinnati,
Director of Finance (Ret.)*

WESLEY SERVICES ORGANIZATION

3333 Glenmore Avenue
Cincinnati, Ohio 45211
(513) 389-3096

ADDRESS SERVICE
REQUESTED

Nonprofit
U.S. Postage
PAID
Cincinnati, OH
Permit No. 529

Mailing Address Line 1

Mailing Address Line 2

Mailing Address Line 3

Mailing Address Line 4

Mailing Address Line 5

May We Help You With Your Outreach Ministry To Seniors? WesleyLinks is an interdenominational consortium of area faith based ministries created by Wesley Community Services to enable partner churches to better serve seniors in their congregations. Services are made available to seniors who need support so that they may stay in their own home for as long as possible. WesleyLinks meets 5 times/year at member churches for a luncheon and informative program. If you are interested in having your church be a WesleyLinks partner, contact Bill Reusing at 513/389-3096.

The WesleyLinks Family of Churches Include:

Anderson Hills UMC
Armstrong Chapel UMC

Brecon UMC
Calvary UMC
Cherry Grove UMC
Cheviot UMC

Christ New Beginnings Ministries
Christ Prince of Peace UMC
Church of the Saviour UMC
Cincinnati Christian University

Clifton UMC
Clough UMC
Eden Chapel UMC
Elberon UMC

Epiphany UMC
First Baptist Church of Dent
Forest Chapel UMC
Friendship UMC

Gaines UMC
Hartwell UMC

Hartzell UMC
Holy Family Catholic Church
Hyde Park Community UMC
Immaculate Heart of Mary Parish

John Wesley UMC
Kenwood Baptist Church
Keys of the Kingdom UMC
Knox Presbyterian Church

Loveland UMC
Miami Whitewater UMC
Monfort Heights UMC
Mt. Carmel Christian Church

Mt. Healthy UMC
Mt. Washington UMC
Nast Trinity UMC
New Vision UMC

North Bend UMC
Oak Hills UMC
Our Lady of Lourdes Church
Our Lady of Visitation Catholic

Church
Parkside Christian Church
Pilgrim United Church of Christ

Sharonville UMC
Shiloh UMC

St. Aloysius Gonzaga Catholic Church
St. Antoninus Catholic Church
St. Bernard Catholic Church
St. Ignatius Catholic Church

St. James Episcopal Church
St. Joseph Catholic Church North Bend
St. Lawrence Catholic Church
St. Luke's Evangelical Church of Christ

St. Martin of Tours Catholic Church
St. Peter and St. Paul United Church of Christ
St. Timothy's Episcopal Church
St. Vincent DePaul Society

State Avenue UMC
Vineyard Community Church
Vineyard Westside
Wesley Foundation United Methodist Campus

Ministry at the University of Cincinnati
Westwood First Presbyterian Church
Westwood UMC
Zion UMC